

# SHPOA

Shadow Hills Property Owners Association

Dedicated to Preserving Rural Community

Volume 34, Issue 1

*A Neighborhood Where Families Grow*



January–February 2011

## Horse Rescue

By Hailie Herrera

At approximately 2:30 p.m. on December 4, 2010, witnesses stated a car driving too fast and too close to a horse and its rider caused what could have been a near catastrophic event. The horse, knowing the car was coming too close, stepped closer to the curb where a pile of leaves were covering a slanted metal drainage grate. As soon as the horse's hooves hit the metal grate she went down and slid right into the drainage trap doors, thus trapping her hooves. The horse's rider Bert Bonnett, a 101-year old Shadow Hills resident, was able to dismount without getting hurt. He stated "That old mare knew that I had to get off her before she started thrashing. Otherwise she woulda hurt me good." Bonnett used to let all the neighborhood kids ride his horses back when they didn't even know what a liability release was. Bonnett broke the mare 14 years ago, and knew she would sacrifice herself to save him.



Another rider who was also riding her horse some distance behind witnessed the incident and immediately called 911. LAFD Fire Department, local veterinarians, Foothill Mounted Patrol (FMP) and Shadow Hills residents were on scene within minutes and began what ended up being a five-hour ordeal. LA City Paramedic Rescue 77 and Truck 74 arrived on scene with USAR ropes and equipment and one of their own, Rene Herrera, a member of the LAFD Mounted Patrol Unit and Foothill Mounted Patrol President. This combination of experience and equipment proved to be invaluable to the successful extrication.

The first thing the LAFD did was shut Wheatland Avenue down completely to create a safe environment to work in. Any commotion from cars, loud voices, poking and prodding would agitate the exhausted mare and cause her to start thrashing about which would in turn drive her deeper into the drainage grates. This created an extremely dangerous work environment for the rescuers trying to keep her from getting up. The challenge was to keep the horse and the bystanders calm until the local vets arrived, about 30 minutes later

*continued on page 9*

## Yard Sale Results

The SHPOA Board wishes to thank all of you again for supporting the yard sale through donations and purchases. We raised \$1,983.00. This will help in the ongoing fights to preserve our lifestyle and keep our newsletter alive. We could not have done it without you!

## Fun Days Coming to Shadow Hills Presbyterian Preschool

Because it's fun, on Friday, January 21, the students and staff at Shadow Hills Preschool will wear their pajamas to school. It's "Pajama Day" and an opportunity to be super casual. So casual in fact, that the students don't even have to dress. They can wake up, roll out of bed and be ready to go to school. Along with the unusual attire, students will be enjoying a simple, healthy breakfast at school. How fun to see students and staff enjoying school in their PJ's!!

Then on Friday, February 25, we have "Silly Hat Day!" We love this day. Students are asked to make a silly hat to wear to school. The purpose is to involve the families, get creative and design a special hat for the student to show their expression of individuality. Every hat is a unique work of art. Staff members join in on the fun and don their creations too. It is so fun to see the amazing creative ideas of our preschool families.

*continued on page 2*

## There's more in store ... in this issue:

Horse Rescue.....	1
Yard Sale Results.....	1
Fun Days Coming to S.H. Presbyterian Preschool.....	1
Hansen Dam Ranger Station Groundbreaking.....	2
Lopez Canyon Update.....	2
Safety Tips.....	4
World Religions Survey.....	4
Watch That Ficus Tree – Don't Trip (Part 3).....	5
Report = Reward.....	6
Pets Are Welcome at S.H. Presbyterian Church.....	7
Winter Pet Safety Tips.....	7
Quicksand.....	8
Mandatory Micro-chipping of Redeemed Pets.....	8
Simplification of Your DWP Bill.....	10
Proposed Amended Fees for Animal Services (Part 2).....	11
Community Plan Updates (Part 1).....	12
Our White Elephant Museum (Part 3).....	13
Beware of Property Liens.....	13
Tax on Medical Marijuana (Part 1).....	15

## 2011 SHPOA Board Members

### Executive Officers

President:	Elektra Kruger	352-6220
	kalkrugers@earthlink.net	
Vice President:	Dave De Pinto	352-7618
	7daviddepinto@ca.rr.com	
Executive Secretary:	Kellie Kozonis	
	kozonis@ca.rr.com	
Recording Secretary:	Katherine Dayen	
	Dayenight1@gmail.com	
Treasurer:	Gerhard Kruger	352-6220
Membership:	Roberta Cole	353-4633

### Appointed Officers

Land Use:	Bill Eick	(W) 248-0050
		(H) 353-6191
	weeick@pacbell.net	
Trails:	James and Andrea Gutman	
	353-5974	
Special Projects:	Karen Burdett	970-1995
	kkburdett89@gmail.com	
Neighborhood Watch:	Sue Mansis	352-3966
	suemansis@shpoa.us	
Outreach: “Lost/Found Pets”	Chris Arlington	353-5534
	Shpoa@shpoa.us	
Webmaster:	Carlos George	
	webmaster@shpoa.us	
Newsletter:		
Editor:	Dave De Pinto	352-7618
	7daviddepinto@ca.rr.com	
Article Collection:	Carol Roper	353-5534
	carlington@ca.rr.com	
Ad Collection:	Dana Stangel	446-0284
	dana@herpfreak.com	
Layout:	Stacey Rigney	
Historian:	Vacant	
Hospitality:	Martha Hankins	951-1669
	marthahankins@msn.com	

**SHPOA’s Mailing Address:**  
**P.O. Box 345, Sunland, CA 91041**

**Website: [www.shadowhillshpoa.com](http://www.shadowhillshpoa.com)**

Printer: Wright Color Graphics  
246-8877

### **Senior Lead Police Officers:**

*Sunland:* Larry Martinez 634-0705  
16A65@mycingular.blackberry.net

*Sun Valley:* Michelle Rodriguez 634-0755  
31020@lapd.lacity.org

### **Foothill Trails District Neighborhood Council (FTDNC):** **[www.ftdnc.org](http://www.ftdnc.org)**

*West Shadow Hills/Stonehurst:*  
Terry Kaiser (818) 262-0315  
area5repl1@ftdnc.org

*East Shadow Hills/East LVT:*  
Dale Gibson 968-8670

### **Emergency Animal Hospitals**

**Animal Specialty Group** [www.asgvets.com](http://www.asgvets.com)  
4641 Colorado Blvd. (off 5 Fwy), Los Angeles 90039  
(818) 244-7977 Mon–Fri: 2pm–8am  
Weekends: 24 hours

**Animal Emergency Centre** [www.valleypet911.com](http://www.valleypet911.com)  
11730 Ventura Blvd., Studio City 91604  
(818) 760-3882 Mon–Thurs: 6pm–8am  
Weekends: Fri 6pm–Mon 8am

## **Fun Days Coming**

*continued from page 1*

Looking ahead to March, we will be having our “Annual Fundraiser Trike-a-thon!”

This is our major fundraiser and we stress the word FUN! It’s a hands-on, child participation event and we can guarantee a good time! More information in the next SHPOA newsletter!

In the meantime, if you or anyone you know are looking for a high quality, hands-on, fun and loving preschool, send them over to Shadow Hills Presbyterian Preschool at Sunland Blvd. and Johanna Ave. We would love to give them a personal tour.

## **Hansen Dam Ranger Station Groundbreaking**

*by Elektra Kruger*

On September 2, Councilmember Richard Alarcon, Jon Mukri—General Manager for the Department of Recreation and Parks, Carvel Bass—Ecologist with the Army Corps of Engineers, Sharie Abajian—Senior Park Ranger and others gathered together to celebrate the groundbreaking for the long-anticipated Hansen Dam Ranger Station.

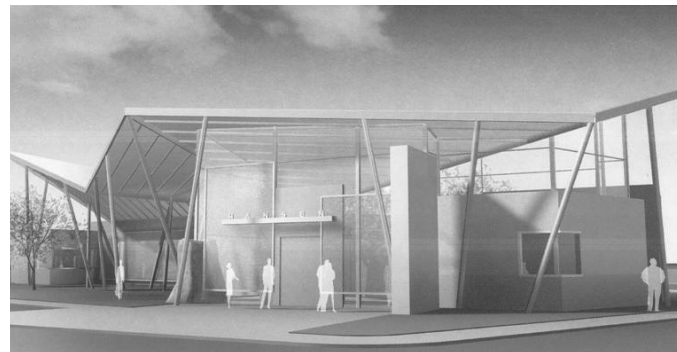

Made possible by Prop K funding, the station will be approximately 4,000 square feet in size providing a public visitor center, offices for the Park Rangers, public restrooms, a community meeting room, a communication center and a storage area for the ATV’s purchased for use by law enforcement in the Hansen Dam basin by the Foothill Trails District Neighborhood Council. Grand Opening is scheduled for late Fall 2011.

Landscaping will grace the Project. The Ranger Station is the first of several projects planned for the Hansen Dam basin with others to include a Campground for inner city youth, a wetlands restoration project which will bio-filtrate water captured from three parking lots surrounding the basin, a 6,000 square foot Skate Park and equestrian trail improvements.

Following the groundbreaking ceremony for the Ranger Station, Carvel Bass along with Paul Davis and others walked along some of the equestrian trails in the basin scheduled for improvements and maintenance with Prop 40 funds.







## Shadow Hills Quiz

By Martha Blessington-Padilla

### AUTUMN SHADOW HILLS QUIZ

By Martha Blessington-Padilla

During my daily walks in Shadow Hills, I see many tracks along the roadside. How many can you match to their owners? (Hint: notice the size range.) Have fun!  
PART A-Match the numbered animal to its track.

1. Coyote \_\_\_\_\_ a. H: 4" F: 1"
  2. House cat \_\_\_\_\_ b. 
  3. Raccoon \_\_\_\_\_ c. 
  4. Cottontail rabbit \_\_\_\_\_ d. H:  F: 2"
  5. Bobcat \_\_\_\_\_ e. 
  6. Mountain lion \_\_\_\_\_ f. H:  F: 2 1/2"
  7. Horse \_\_\_\_\_ g. H: 4" F: 2 1/4" - 4"
- PART B- Choose A or B

1. \_\_\_\_\_ A- your neighbor B- the San Gabriel Mts. Yeti

2. \_\_\_\_\_ A- Dog

B. Skunk

Answers on page \_\_\_\_\_

Today's source- Ma. Division of Fisheries and Wildlife

Coming next Newsletter- Identifying dog and cat tracks.  
What do you look for?

Answers on page 14

## Safety Tips

by Officer Larry Martinez, LAPD Crime Prevention Section

Automated Teller Machine (ATM)

- If you must use an ATM, choose one that is located inside a police station, mall, or well-lighted location. Withdraw only the amount of cash you need.

- Protect your PIN by shielding the ATM keypad from anyone standing near you.

- Do not throw your ATM receipt away at the ATM location.

Shopping

- Dress casually and comfortably.

- Avoid wearing expensive jewelry.

- Do not carry a purse or wallet, if possible.

- Always carry your California Driver License or Identification Card along with necessary cash, checks and/or a credit card you expect to use.

- Even though you are rushed and thinking about a thousand things, stay alert of your surroundings.

- Avoid carrying large amounts of cash.

- Pay for purchases with a check or credit card when possible.

- Keep cash in your front pocket.

- Notify the credit card issuer immediately if your credit card is lost, stolen or misused.

- Keep a record of all of your credit card numbers in a safe place at home.

- Be extra careful if you do carry a wallet or purse. They are the prime targets of criminals in crowded shopping areas, transportation terminals, bus stops, on buses and other rapid transit.

- Avoid overloading yourself with packages. It is important to have clear visibility and freedom of motion to avoid mishaps.



## Before There Were Cellphones...

by Marlene Hitt, Sunland Archivist, Bolton Hall Museum

Whether it is yodeling, Mom yelling down the street, a dinner bell or the whistle of a factory noon bell, people just must communicate with each other in one way or another.

So a variety of ways to communicate were invented. For the settlers in Sunland and Tujunga in the 1920s, a telephone system was well under way. By the end of that decade 22 subscribers had signed up for phone service. The first number recorded was "24", Caul's Place. Even in 1940 the drug store in Sunland had the easy number of "85".

The line at that time was strung from Glendale with services limited to 1 and 1/2 hours morning and evening.

continued on page 6



## World Religions Survey

By Laura Barker

We no longer live in an exclusively Christian culture. Our neighbors represent a wide variety of faith traditions. Beginning Sunday, January 16, 2011, Shadow Hills Presbyterian Church will begin a worship and study focus on "Christianity and World Religions: Wrestling with Questions People Ask." Hinduism, Buddhism, Islam, Judaism, and Christianity will each be surveyed, compared, and contrasted during study groups on Sundays at 7:00 p.m. During the 9 a.m. praise celebration and the 10:30 a.m. worship service each Sunday morning, we will explore how each tradition relates to our own daily life and faith. For additional information, see [www.shadowhillschurch.com](http://www.shadowhillschurch.com).

## Watch That Ficus Tree – Don't Trip – Part 3

by Elektra Kruger

In mid-January 2010, the Bureau of Street Services (BSS) provided a report to the City Council's Public Works Committee in response to a Motion introduced by Councilmember Jan Perry in mid-October 2006 regarding the conflict between Ficus trees, sidewalks and other infrastructure. According to the BSS, the conflicts between sidewalks and the Indian Laurel Fig tree (the Ficus tree), or any other large stature tree for that matter, are mainly due to the "large size" vs. "available space" ratio.

Large street trees require adequate space to grow, space not always provided when planted in tree wells adjacent to sidewalks. The large majority of a tree's roots are contained within 24–36 inches of the soil-surface. Lack of needed space can result in off-grade sidewalks. According to the BSS, this situation is best remedied by frequent tree root pruning to contain the root system within its minimal space, enlarging tree wells, or modifying the surrounding growing space (by e.g. utilizing a meandering sidewalk design or replacing concrete sidewalks with an alternative such as rubber sidewalks bordering the tree wells). Tree removal should be viewed as a last resort option.

Indian Laurel Figs are one of the large tree species with the highest root pruning tolerance, though most large stature trees are generally quite adaptable to root pruning (less than 5 percent of trees impacted by the City's Sidewalk Repair Program needed to be removed). It is estimated that a healthy tree can withstand the loss of 30 percent of its root mass and many species even as much as 50 percent (at a minimum distance of 1 foot from the trunk flare for every inch of tree diameter at 4.5 feet above ground).

It usually happens that necessary pruning of street tree roots would be closer to the root flare than this recommendation due to the small size of tree wells. Thus the Urban Forestry Division will usually root prune only one side of the root plate during sidewalk repair projects—the sidewalk side which is generally the side responsible for off-grade conditions.

The BSS report, in response to the idea presented in Councilmember Janice Hahn's Motion regarding establishing a pilot program allowing for 20 annual permits for full Ficus tree removal, stated that it is the City's policy to preserve street trees wherever possible for the sake of retaining the positive environmental features they provide and thus there must be a strong and justifiable reason for requesting their removal. Such reasons might include:

- Poor health of a tree creating a potential public hazard
- Conflict with other infrastructure
- A tree impacting a street widening project
- Obstruction of driveway or sidewalk installation
- Obstruction of any public improvement project.



## **Before There Were Cellphones** *continued from page 4*

The switchboard was in the home of whoever was operating it. By 1918 the consolidation of the Sunset and Home Telephone Companies made it possible to phone from Tujunga on the line of either company without having to travel to La Crescenta to use the Home Company lines.

By 1922 the Sunland Telephone Company had a night operator on duty from 10:30 p.m. to 6:30 a.m. By 1939 growth of the town expanded to the installation of 1,060 phones in the Tujunga Valley.

From the Sunland Rural Telephone Directory 1950, we find the suggestions of the company to their customers: “Evening and night rates applicable from station to station in effect between the hours of 8:30 p.m. and 4:30 a.m. The minimum evening rate and night rate is 25 cents.” There is no mention of the day rates other than they are much less. Then: “To facilitate sending telegrams and cablegrams, patrons should call by name—as ‘Pacific Telegraph’.” We sometimes forget that each call was placed through a live operator and those women were kind and helpful.

On the issue of “Complaints,” we have the following: “The company appreciates prompt reports of specific instances of unsatisfactory service. Call ‘Complaint’. Operators are required to be courteous in their dealings with subscribers, but are not permitted to engage in conversation beyond that necessary to complete connections.”

A great marvel came when we could use direct dialing to any place in the world.

We started here in town with two numbers and now find ourselves not with the simple chore of asking an operator to call your dad at 85 to the practice of punching in 11 numbers on a touch phone or cell. What a need we all have to communicate! Of course now the electronic media keep all of us informed and easily connected. And now, what is next?

---

## **Report = Reward**

*By Sue Mansis*

Catch someone illegally dumping and receive \$1,000. Get license plate #, description of the vehicle, address of the property, and then call 3-1-1. Especially helpful is calling when the dumping is “in progress.” In an effort to crack down on illegal dumping of all trash/bulky items/landscaping trimmings/car parts, tires, etc. the City is offering up to \$1,000 reward for anyone observed - day or night. Please be careful and discreet but be sure to call as soon as possible so authorities can act quickly.

---

## **Mitigation Bank Emergency Number**

Sheriffs Number to call if you are in the Mitigation Bank area of Hansen Dam: (800) 834-0064. They WILL respond! The boundaries for the Mitigation Bank are Foothill Boulevard to the east, past Wheatland Avenue to the DWP power lines to the west, Wentworth Avenue to the south, to Foothill Boulevard to the north.

## **Pets Are Welcome at Shadow Hills Presbyterian Church!**

Fluffy and Fido won't want to miss an outing to God's house to join their four-legged friends in praising the Lord. The casual "Pets are Welcome Service" (PAWS) at Shadow Hills Presbyterian Church gathers animal lovers and their beloved companions for song, prayer, a short message, and time together. PAWS is held each Sunday at 5:00 p.m. in the little chapel. Although chairs will be provided for people, special PAWS Pads are provided for pets, along with a biscuit blessing. For additional information, see [www.shadowhillschurch.com](http://www.shadowhillschurch.com).



### **Winter Pet Safety Tips**

*by Denise Fleck*

**Don't leave pets outdoors when the temperature drops.** Regardless of the season, shorthaired, very young, or old pets should never be left outside without supervision. Short-coated dogs may feel more comfortable wearing a sweater during walks. If you know of an outdoor dog, make sure he is protected by a dry, draft-free doghouse that is large enough to allow the dog to sit and lie down comfortably, but small enough to hold in his body heat. The doghouse floor should be raised a few inches off the ground and covered with straw and blankets. It should be faced away from the wind, and the doorway should be covered with waterproof burlap or heavy plastic.

**Make sure pets stay well-hydrated.** Although we generally think of Heat Stroke during the hot Summer months, with the heat on in our homes and cars, make sure your pets—in their warm, fuzzy coats—do not get overheated and always have plenty of fresh water.

**Warm engines in parked cars** attract cats and small wildlife which may crawl up under the hood to get warm. To avoid injuring any hidden animals, bang on your car's hood to scare them away before starting your engine.

**Watch the calories** since most pets are less active this time of year, take care that they don't pack on the pounds. However, if you do have an outdoor pet, it may be advisable to increase his caloric intake (check with your veterinarian) so that he can generate the necessary body heat lost during colder days.

**Antifreeze is a deadly poison**, but it has a sweet taste that attracts animals. Take care to quickly wipe up spills and store antifreeze (and all household chemicals) out of reach. Better yet, use antifreeze-coolant made with propylene glycol; if swallowed in small amounts, it will not hurt pets. Should your pet ingest antifreeze or other poisons, make sure you know what to do or call the ASPCA's Poison Control for assistance (888) 426-4435.

## Quicksand

*Copied From Trails Project Partnership*

Just in case we ever get rain again, now is the time to remind you that you may come across quicksand in Hansen Dam. The good news is that quicksand is not the monstrous force portrayed in movies or TV. Sinking out of sight into a bottomless pit may be our nightmare, but that's not the way quicksand works. So forget about the image of the cowboy's head disappearing as his flailing hands reach for the rope that his faithful horse, standing on the bank, has tossed to him.

Quicksand is just sand that has been over-saturated with water, creating a mixture that no longer supports weight. Quicksand won't suck you down, and it is rarely more than a few feet deep. However, you can trap yourself if you don't know how to respond. Thrashing vertical movements will force you deeper. Slow, steady movements are best.

"That's fine for me," you might be thinking, "but what about my horse? Try telling HIM to stay calm!" Well, that is exactly what you need to do. Our horses look to us for leadership. If we remain calm, it increases the likelihood that they will remain calm. Here are some tips for navigating wet winter trails:

- Stay on high ground.
- Use trails that are well traveled and show hoof prints. If others have passed safely (and you can see from their tracks how deep they sank) then you probably can too.
- Avoid places which appear smooth and trackless. Liquefied sand doesn't hold hoofprints or rocks. No rocks, don't go.



## Mandatory Micro-chipping of Redeemed Pets

*by Elektra Kruger*

At its March 5, 2010 session, the Los Angeles City Council voted to have the City Attorney's Office prepare and present an Ordinance requiring any cat or dog redeemed by its owner from a Los Angeles Animal Shelter to be micro-chipped. A draft copy of that Ordinance was submitted to the City Council's Public Safety Committee in early July 2010 for their review and recommendation. The Ordinance requires the implantation of an electronic identification device (micro-chip) in every dog or cat redeemed from an Animal Services shelter by its owner for a cost of \$15. The draft Ordinance was approved by the Committee at its meeting in mid-July 2010.

Any owner may, at any time, elect to have an electronic animal identification device provided and implanted in their dog or cat by the Animal Services Department for a fee of \$25. There are periodic "micro-chip clinics" sponsored in the community by a variety of organizations at reduced rates.

SHPOA strongly recommends that every pet owner micro-chip their pets. The \$25 fee is worth avoiding the heartbreak of losing a pet that has inadvertently escaped through an open door or gate. Do not be so naive as to

*continued on page 10*



## Horse Rescue

*continued from page 1*

Once the vets were able to tranquilize the mare, LAFD members were able to set up their USAR harness pulley system to pull and load the mare onto a SKED device (essentially a large piece of heavy duty plastic like a snow sled). Once the mare was pulled onto the device they were able to slide the mare about 100 feet from the grates and onto a neighbors lawns. This became the onsite treatment zone for the next four hours.



Bert Bonnett was at his mare's side the entire time. Doctors Bradley, Robertson and Renee worked hand-in-hand with the LAFD trying to sedate, extricate and assess the mare's future quality of life. Their patience, guidance and team effort allowed less-experienced volunteers feel comfortable and helpful. This trio of vets should be commended. At the end of the evening, with heavy doses of medication, countless numbers of stitches, I.V. fluids and two hind legs wrapped, the mare was helped to her feet. With her head hung low, the mare was taken to her stall that was freshly lined with straw and put under 24-hour care.



Hopefully Mr. Bonnett was able to get some sleep, even if it was in a sleeping bag right next to his good ole mare. When asked how he is still able to ride after all these years, when guys half his age can barely get on a horse, he stated "The reason I've lived so long is because of good whisky, beautiful women and fast horses." With the help of LAFD, amazing veterinarians, and a group of dedicated neighbors, a man and his horse would be able to ride together another day.

*Editors note: Due to the extent of injuries, the mare had to be euthanized the next day.*

Corral 20 is planning to actively address the equine/auto problem, and the Foothill Mounted Patrol will be working closely with them. There will be a meeting in early January to gather info to share with the community. Watch for an email blast from shpoa@shpoa.us. If you have not signed up for the SHPOA email, please do so.

## **Mandatory Micro-chipping** *Continued from page 8*

believe it cannot happen to you. How many times have you seen posters tacked to telephone poles by grief stricken owners about lost pets being such an integral part of the family? Often exorbitant reward monies are associated with these pleas - much more than \$25.

By the way, if you should ever happen to come across an animal that appears to be lost, even if you do bring it to the pound, also take a picture of it first and ask SHPOA to send a notice over [shpoa@shpoa.us](mailto:shpoa@shpoa.us) regarding the animal, where it was found and where it is currently located. Also, SHPOA has a microchip scanner. Please call Carol or Chris at 353-5534 for an appointment. The hearing regarding the mandatory micro-chipping of redeemed pets was scheduled to be heard in City Council on August 3, 2010. SHPOA will inform you of the outcome of the Council vote and the date the Ordinance will become effective if approved.

*Update: Ordinance became effective September 17, 2010.*

---

## **Simplification of Your DWP Bill**

*by Elektra Kruger*

In a prior issue, we provided a listing of things found on our DWP bills that are confusing, duplicated, having multiple account numbers, having unexplained code numbers and having difficult to understand billing terms and charges. In response to these recognized issues, in late September 2009, Councilmember Jan Perry presented a Motion to City Council asking that the Council call upon the DWP to file a report with the Council in 30 days on its billing procedures, use of account numbers, use of billing inserts and any suggestions on how to improve customer understanding of billing terms and charges, how to reduce costs and how to build greater trust among customers. The Motion was referred to the City Council's Energy and Environment Committee for its review and recommendation.

Before the City Council could ever demand the report of the DWP which is to be due in 30 days, the Motion must come out of Committee. The Motion was referred to the Committee in late September 2009 and was first scheduled to be heard in Committee in early January 2010, more than three months later. It was continued to be heard at the Committee's mid-February meeting at which time it was again continued to be heard 30 days later. Guess they can't count—the next scheduled date was 6 months later for their mid-August meeting at which time it was yet again continued to their next meeting.

Do you think it took anyone in City Council this long to decide to raise their own salaries or extend their allowable terms in office. For crying out loud, this is not asking anyone to write the Odyssey - only to ASK the DWP to prepare and submit a report to the Council at a later date. Is that so hard? As of late September, this item has not yet been re-agendized to an Energy and Environment Committee meeting although the DWP has submitted a report on a proposed new design for its bills.

I have to admit, the proposed new design is a great improvement over the current design of our DWP bills—much easier to understand. SHPOA will let you know where we go from here in future issues.

## Proposed Amended Fees for Animal Services – Part 2

*By Elektra Kruger*

In late March 2009, the Office of the City Attorney submitted a draft Ordinance to City Council related to amending a number of sections in the LA Municipal Code dealing with fees charged for a variety of services rendered by the Department of Animal Services. The new proposed Ordinance will continue to allow the General Manager of the Animal Services Department to waive adoption and micro-chipping fees for various non-profit rescue or humane organizations, but will not extend that waiver authority to spay/neuter or licensing fees.

The authority of the General Manager to reduce or waive ALL fees, including dog license fees, would be expanded to cover local, municipal or county animal control agencies or any entity responsible for enforcing animal related laws and any Society for the Prevention of Cruelty to Animals (SPCA). The proposed fee schedule actually reflects a decrease in adoption fees for dogs and cats from \$55 to \$47 for dogs and from \$29 to \$21 for cats. That \$8 decrease in adoption fees reflects a corresponding increase of \$8 in the spay/neuter fees from \$32 to \$40 in order to maintain the same overall total adoption costs.

What rocket-scientist on the City payroll spent days mulling over his mathematical notes on the taxpayers payroll to come up with that magical formula? Rabbits would also be required to be spayed/neutered at the same \$40 rate as for dogs/cats. The proposed Ordinance offers what it claims to be a 50% discount for relinquishment of an equine animal. The City's Administrative Officer determined that the actual cost involved with the relinquishment of an equine runs \$445.23 and for relinquishment with pick-up runs \$651.08. But the City recognizes how hard this may be on its resident's pocket book and generously applied a 50% discount to \$223 for equine relinquishment and \$326 for relinquishment with pick-up.

In 2006, City Council approved an adoption fee of \$40 for rabbits with the entire fee to be deposited into the Animal Sterilization Fund. This new proposed Ordinance would reduce the adoption fee for rabbits to \$16, but would require a \$40 sterilization fee prior to adoption for a total adoption increase to \$56. Seems like the rocket scientist was still at work. To be continued in a future issue.

---

### Parking in Front of Driveways?

*by Elektra Kruger*

Parking demand often, by far, exceeds available street parking in many residential areas. While the California Vehicle Code does not allow on-street parking in front of driveways in general it does, however, allow local jurisdictions to permit this parking option by means of a local permit process.

Because parking options are often so severely limited, in late October 2010, Councilmember Bill Rosendahl presented a Motion to City Council asking that they request the Department of Transportation to report on the steps necessary to implement this California Vehicle Code Exemption to allow residents to legally park in front of their own driveways. The Motion was referred to the City Council's Transportation Committee for their review and recommendation.

## Community Plan Updates – Part 1

by Elektra Kruger

State law requires local government planning agencies to prepare a General Plan which is a City's planning guide, however, it does not specify how often those plans must be reviewed. The Los Angeles General Plan's 35 Community Plans are the official guide to future development within the City, however, the Los Angeles Municipal Code specifies nothing relative to Community Plan updates or revision timelines.

Many of LA's Community Plans, including our own, are woefully out-of-date. Any hope, however minimal, of retaining our quality of life is dependant on regularly updating Community Plans. A City Charter amendment requiring Community Plans to be updated every ten years would ensure that the City's Community Plans reflect the planning vision of community stakeholders.

In recognition of this, in mid-October 2010, Councilmembers Eric Garcetti and Ed Reyes co-presented a Motion to City Council asking that the Council request the Planning Department and City Attorney's Office to prepare a proposal for a Charter amendment to be placed on the March 2011 ballot requiring all City Community Plans be updated every ten years.

The Motion was referred to both the City Council's Planning and Land-Use Management Committee and Rules and Elections Committee. The Rules and Elections Committee reviewed the Motion at their October 27, 2010 meeting. In 2011, 31 of the City's 35 Community Plans will not have been updated in more than 10 years. If the proposed Charter Amendment were to be approved, those 31 Plans would immediately be deemed "out-of-compliance".

At its current staffing levels, the Planning Department can only pursue updates of a few Community Plans at any one time. For those of you who are not aware of this, updating the Sunland/Tujunga et al Community Plan was begun, but then was dropped because Planning Department staffing levels could no longer handle the workload due to reduction in personnel as a result of the City's budget crisis. To be continued in future issues of the SHPOA newsletter.



## The Equestrian Beat

by Vikki Brink, FTDNC Equestrian Committee Chair

The FTDNC Equestrian Committee has always met on the second Thursday of each month. We felt there may be too many meetings for one person to take in. so we decided to continue to have meetings but to change the format every other month to invite an expert to come and talk on different subjects regarding the equines in our life. The first of these meetings was held on Thursday the 4th of November with the topic of colic in horses. Dr. Heidi Agnic came and donated her time to explain how and why horses acquire colic, how to catch it early, what to do and how to prevent it. We had a nice turnout and hopefully she will return to talk on another subject. The subjects are up to the community. I invite you to contact me about what you would like to have discussed and I will find the expert to talk about it.

Another part of this committee's involvement will be to work with developers to get them to adhere to standards for trails – so they are both attractive and functional. Two unfolding projects now are La Tuna Canyon/Ledge trails and the Lopez Canyon Land Field trail system. If you want to get involved contact me at summerhawkranch@hotmail.com and jump onboard.

## S.A.F.E. Collection Center

S.A.F.E. Centers are open every weekend. Our local Center is open Saturday, Sunday and Monday from 9 a.m. to 3 p.m. The Sun Valley S.A.F.E. Center is located at 11025 Randall Street. Take Sunland Boulevard towards I-5, turn right on Tuxford then right at the first street. Proceed to the end, turn left on Randall and the Center is on your right. It is easy and quick. You are not allowed to get out of your vehicle so have the stuff available for easy access.

## **Beware of Property Liens**

*by Elektra Kruger*

As part of the annual brush clearance process, the LAFD is sometimes forced to assess liens on properties that are out of compliance. These liens stay with the property and not the owner, thus responsibility for payment of the liens could fall on a subsequent buyer.

We have all heard the phrase “buyer beware”. It does remain the responsibility of any new property owner to research any history of liens, but how many of us know all the many things we really need to take it upon ourselves to research when purchasing a house and how many of us would even begin to know how?

Councilmember Dennis Zine feels the City should do all it can to simplify this process for us. Currently, LAFD liens may not even show up on a property’s chain of title where other liens can be found. They are obscurely filed on a supplemental form called a “9-application”. If this is overlooked during the process of purchasing a house, a buyer ends up responsible for paying a lien that should belong to the prior owner.

*continued on page 14*



## **Our White Elephant Museum – Part 3**

*by Elektra Kruger*

The City Controller ran an audit of the Los Angeles Children’s Museum with the objective of determining the Museum’s funding sources and how those funding sources were intended to be used to bring the Museum to the point of celebrating its Opening Day. The audit resulted in a report with nine significant findings and recommendations for dealing with them.

The first recommendation called for a review of the Museum’s plans to bring the entire Project to fruition and offered some alternative plans should the Museum fail to meet its own funding goals. The Los Angeles for Kids Steering Committee submitted a report to the City Council with its response to the findings/recommendations. Relative to reviewing the Museum’s plans for raising the \$22 million that will be needed to complete the entire project including fabrication of exhibits, etc., the Committee claims that City Staff is meeting with Museum representatives on a regular basis to ensure that efforts to raise needed private funds are in full swing. They note that State and City funds committed to the Project are for construction only and cannot be used for fabrication of exhibits.

As of early November 2007, the Museum had received pledges for private contributions in the amount of \$15.7 million toward the exhibit program, \$12 million of which were raised in the four prior months of July 2007 through October 2007. This is in comparison to the \$7.4 million that was raised in total between all the YEARS of 2000

*continued on page 14*

**Beware of Property Liens** *Continued from page 13*

LAFD liens should be listed on a property's chain of title where buyers, escrow companies and title companies can be easily aware of these liens and the responsible person can be held liable to pay all liens on the property prior to a sale. In early June 2010, Councilmember Zine presented a Motion to City Council asking that the LAFD submit a report to the Public Safety Committee including an explanation of its current accounting system for tracking brush clearance along with any other liens assessed against a property by the LAFD as well as a plan to improve that system by seeing to it that all pending liens appear on a property's chain of title.

The Public Safety Committee heard this item in late June at which time the Committee requested a report from both the Fire Department and the City Engineer to be submitted to and reviewed by the Committee in 30 days. SHPOA will keep you abreast of the progress of this issue.



**White Elephant Museum** *Continued from page 13*

and May of 2007 as a result of poorly managed fund-raising efforts. And we wonder why the Museum has taken so long to complete construction alone, much less begin fabrication of its exhibits.

The Steering Committee feels that the Museum will now continue to successfully raise the balance of funds needed to complete the Museum Project. City Staff is requesting monthly budget reports and funding updates from the Museum to make sure that the Museum will continue to raise needed funds for the exhibit program as well as on-going operation costs.

The second finding of the Controller as a result of the Museum audit determined that chances are that the Museum would be able to secure funding to complete construction of the Museum but that once it opens it will also need to raise at least \$2 million annually from private donations to support on-going operations. If the Museum cannot raise these annual funds, the City may be called upon to subsidize the Museum. Saga to continue in our next issue.



**Small Animal Rescue Team**

There is a group called "Small Animal Rescue Team Los Angeles" which is excellent at rescuing small animals (including wildlife). They are a dedicated group of animal rescue officers who are well trained, caring, well equipped, etc. These people are the ones to call, not the police fire department or animal regulation services. They can be reached at (213) 305-4095, [animalrescueteamla@yahoo.com](mailto:animalrescueteamla@yahoo.com), or the following website: [http://www.laanimalservices.com/about\\_smart.htm](http://www.laanimalservices.com/about_smart.htm).

## Tax on Medical Marijuana – Part 1

by Elektra Kruger

Due to its fiscal crisis, the City of Los Angeles is seeking new revenue streams. The passage of State Proposition 215 – the Compassionate Use Act – in 1996 legalized use of marijuana for medical use, but left establishment of guidelines to local jurisdictions. The sale of Medical Marijuana had been considered taxable, but concerns were raised about the legality of marijuana sales and business activity as the basis for a tax as well as taxing co-op memberships and operations.

But a tax on cultivation would not trigger concerns associated with sales activity, rather the activity of the grower. In early February 2010, Councilmember Janice Hahn presented a Motion to City Council asking that they request the City Attorney together with the City's Administrative Officer to prepare and present necessary documents to place a tax on the cultivation of Medical Marijuana on a Citywide Ballot in March 2011. Further, the Motion requested that the Administrative Officer evaluate the impact such a tax might have on the City budget. The Motion was referred to both the City Council's Rules and Elections Committee and Budget and Finance Committee.

In late October 2010, the Chief Legislative Analyst submitted a report to the Rules and Elections Committee reminding them that there were actually two Motions on the radar dealing with Marijuana taxation, one in the context of cultivation of Medical Marijuana and one that would establish a tax on recreational Marijuana should Proposition 19 on the November 2010 ballot pass. (Update: Prop. 19 did not pass).

A prior enactment of a City Ordinance to allow, under strict conditions (?), the operation of Medical Marijuana Collectives has raised the question as to whether or not the City should be able to impose a tax on this type of operation. According to the City Attorney, a tax on Medical Marijuana could be on a "sales-tax" basis or "business-tax" basis. To avoid legal concerns related to recognizing Medical Marijuana dispensaries as "businesses," the City's Medical Marijuana Ordinance was based on the concept of "collectives" - not a business, but a group of people contributing to a cause. No gross receipts, no paying customers and thus no basis for a sales tax or a business tax.

The tax basis of the current City's Medical Marijuana Ordinance is a tax per plant when it is initially planted. The "cultivation tax" is supposed to be imposed per plant regardless of whether the plant actually grows, matures or is harvested. It would not be a "sales tax" on any transaction between individuals in a collective. Theoretically such a tax would be determined by a grower stating the number of plants they intend to grow, the grower submitting a tax statement to the Office of Finance for that number of plants and will receive a tag for each plant taxed. To be continued in future issues of the SHPOA newsletter.

PRSR STD  
U.S. POSTAGE  
**PAID**  
GLENDALE, CA  
PERMIT NO. 1587

**EAST VALLEY  
ANIMAL SHELTER  
NEEDS BLANKETS,  
TOWELS, TOYS and TREATS  
FOR CATS AND DOGS**

**PLEASE BRING ITEMS TO  
EAST VALLEY FEED & TACK**



*Mark your calendar . . .*

**SHPOA General Meeting - January 11, 2011 - 7 pm • Tierra Del Sol**

**Guide to Advertisers**

Page	Page
Airtight Pest Control..... 10	Michael Rich Real Estate ..... 10
Armstrong Insurance ..... 15	MicroArtisans ..... 11
Brush Clearance..... 11	Mission Valley Bank..... 11
C & M Printing ..... 8	Natalie Blancardi, Realtor..... 15
Century 21–Fran/Ray ..... 6	Paul Mattox Hardwood Floors .... 10
Chimney Cleaning ..... 6	Randy's Property Maintenance..... 8
Corky's Bookkeeping ..... 5	Richard Caruso Construction ..... 6
Dale's Automotive ..... 3	Richard's R.R. Plumbing..... 15
David Robertson, DVM..... 12	Sharon Yoho, Realtor ..... 8
Digital Doctor, Don Delson ..... 9	SIG Property Management..... 7
Don Dunham, Attorney ..... 7	Slip Free Solutions ..... 10
Eagle Plumbing ..... 5	SoilDirect.com ..... 15
East Valley Feed..... 5	Sparkle & Shine..... 7
Joe's Bar & Grill/Champs ..... 9	Trish Ramsey Real Estate..... 5
John Nelson Plumbing..... 11	Veronica Allen, Tax Specialist..... 6
Kevco..... 14	William E. Eick, Attorney..... 9
LA Law Center ..... 11	WRD ..... 8
Mary Ann Geyer–Realtor..... 12	Wright Color Graphics ..... 14

**Key Community Locations & Contact Information**

- All Nations Church: 10000 Foothill Blvd., Lakeview Terrace
- Bolton Hall: 10110 Commerce Ave., Tujunga (818-352-3420)
- Lakeview Terrace Recreation Center: 11075 Foothill Blvd., Lakeview Terrace
- Shadow Hills Presbyterian Church: (Johanna/Sunland Blvd. intersection); Pastor Janet Winslow (818-353-3500)
- Stonehurst Park: 9901 Dronfield, Sun Valley (818-767-0314)
- Stonehurst Elementary School: 9851 Stonehurst Ave., Sun Valley
- Tierra del Sol: 9919 Sunland Blvd., Shadow Hills
- Village Christian School: 8930 Village Ave., Sun Valley
- City of LA East Valley Municipal Building/Office CD2 Councilman Paul Krekorian; 7747 Foothill Blvd., Sunland

**Community Calendar**

- Wednesday, December 15**
  - Shadow Hills Presbyterian Church preschool Christmas performance
  - 11:30 a.m. (see attached article)
- Sunday, December 19**
  - Shadow Hills Presbyterian Church Caroling Christmas
  - Info at 818-353-2500
- 1st Tuesday, Every Month**
  - 8 a.m.–10 a.m.
  - LAPD Communittee Coffee
  - Albertson's/Starbucks, 6240 Foothill Blvd.
- 1st Tuesday, Every Month**
  - 7 p.m.
  - FTDNC Land-Use Committee meeting
  - 9749 Wheatland Ave.
- 3rd Tuesday, Every Month**
  - 7 p.m.
  - Neighborhood Watch
  - East Valley Municipal Bldg.
- 3rd Wednesday, Every Month**
  - Shadow Hills Presbyterian Church
  - "Prime Timers 60+"
  - Call church 818-352-2500
- 4th Tuesday, Every Month**
  - 7 p.m.
  - Hansen Dam Park Advisory Board
  - Lakeview Terrace Recreation Center
- 3rd Thursday, Every Month**
  - 7 p.m.
  - Location variable, check website for location [www.ftdnc.org](http://www.ftdnc.org)

**IMPORTANT CITY NUMBERS**

- Dial 311 – Info on all City Services
- L.A. Dept. of Water & Power (800) 342-5397
- Street Service ..... (800) 996-2489
- Large Item Pickup..... (800) 773-2489
- Abandoned Car ..... (800) 222-6366